

NOTICE: This number is original and is the property of the Personal Social Service Bureau. It is yours for presentation only. It may not be sent wholly or in part to any magazine for publication without permission from this Bureau.

Speaker---

The "Elect Lady" with whom we are familiar as the fifth point of our Star lived in Asia Minor, near Ephesus. She and her three sons were members of one of the Churches served by John the Evangelist. They were very wealthy, but also generous and shared their wealth with those less fortunate than themselves, relieving much human distress. For this reason Electa as she is known to us, became a living example of the Spirit of the Master. She was distinguished for her generous hospitality and loving kindness to the poor and suffering. We are impressed, not alone by her generosity but also by the motive which prompted it. She was indeed putting into practice that great law laid down by Christ--"Thou shall love thy neighbor as thy self." Lights are lowered.

Music for marching--America the Beautiful.

Fourteen sisters enter wearing white dresses and short red crepe paper capes. Each carries a lighted red taper in a crystal holder. Seven of these sisters enter thru the preparation room and seven through the Chapter room door. They march to a position as shown in the diagram below. This forms the "Cup" the emblem of Electa's station.

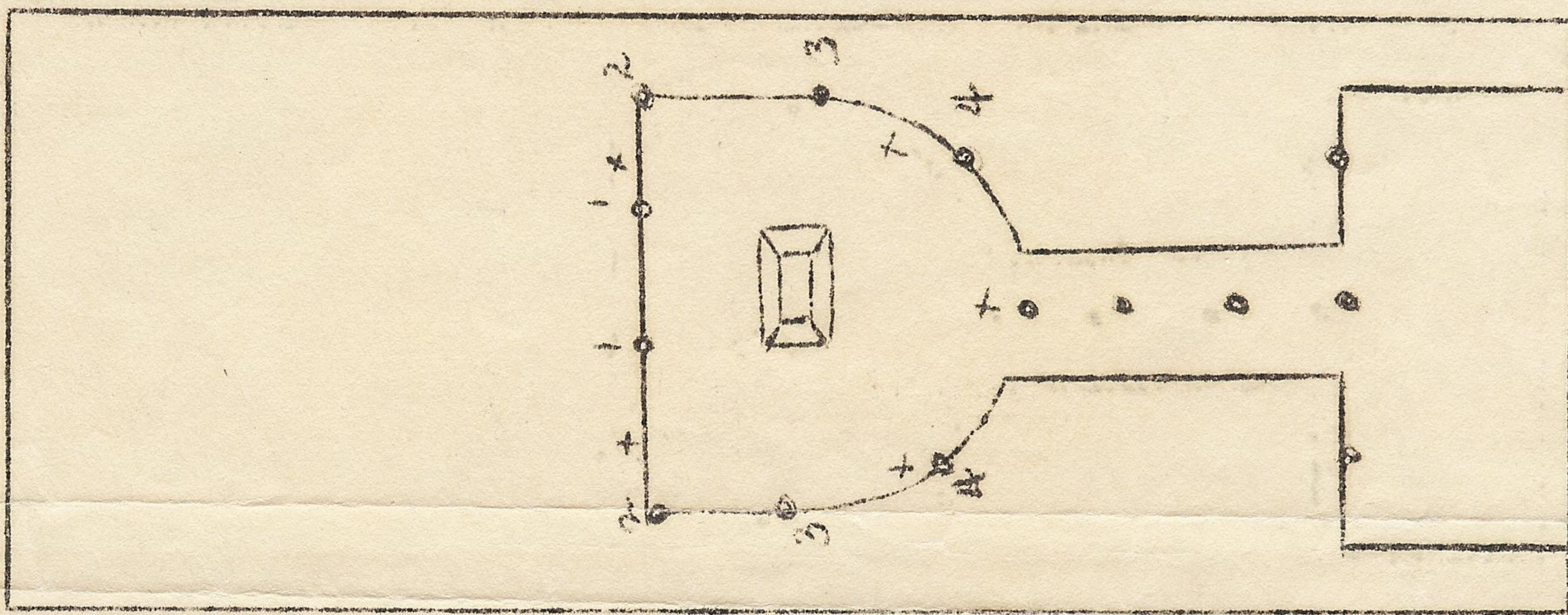

When this position has been reached the Speaker says---

The cup is an emblem of generous hospitality. Let us all be more zealous in emulating the gracious and loving hospitality of Electa. Song is sung as solo. Tune "America the Beautiful"

Electa's hospitality
Was known both far and wide.
She loved her God and fellow men
She had Christ for her guide.
O Charity, Sweet Charity,
May we to all be kind,
And bravely tread the paths of right
For there's where truth we'll find.

At the close of the song the sisters march as shown on the next page forming a cross.

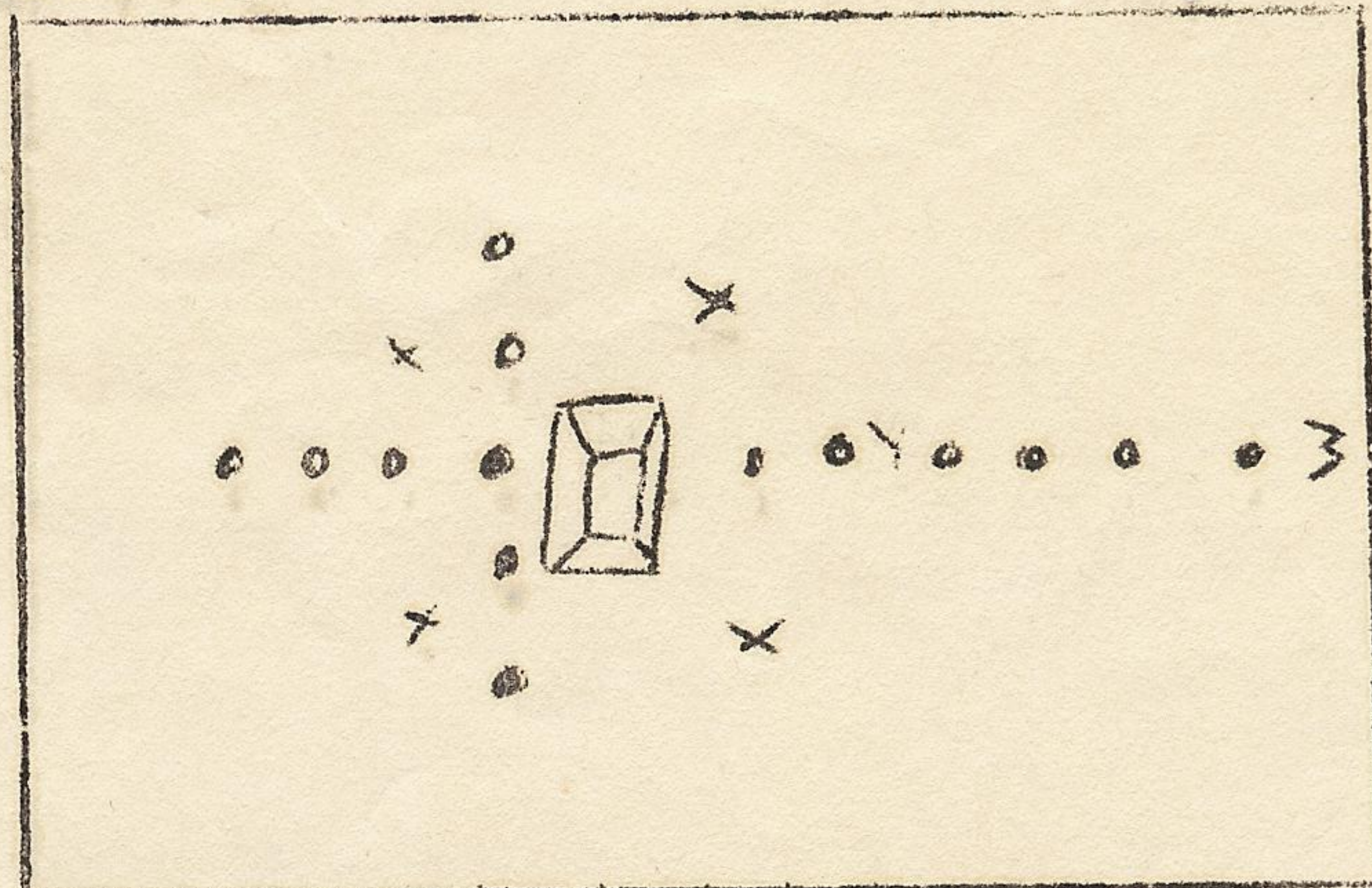
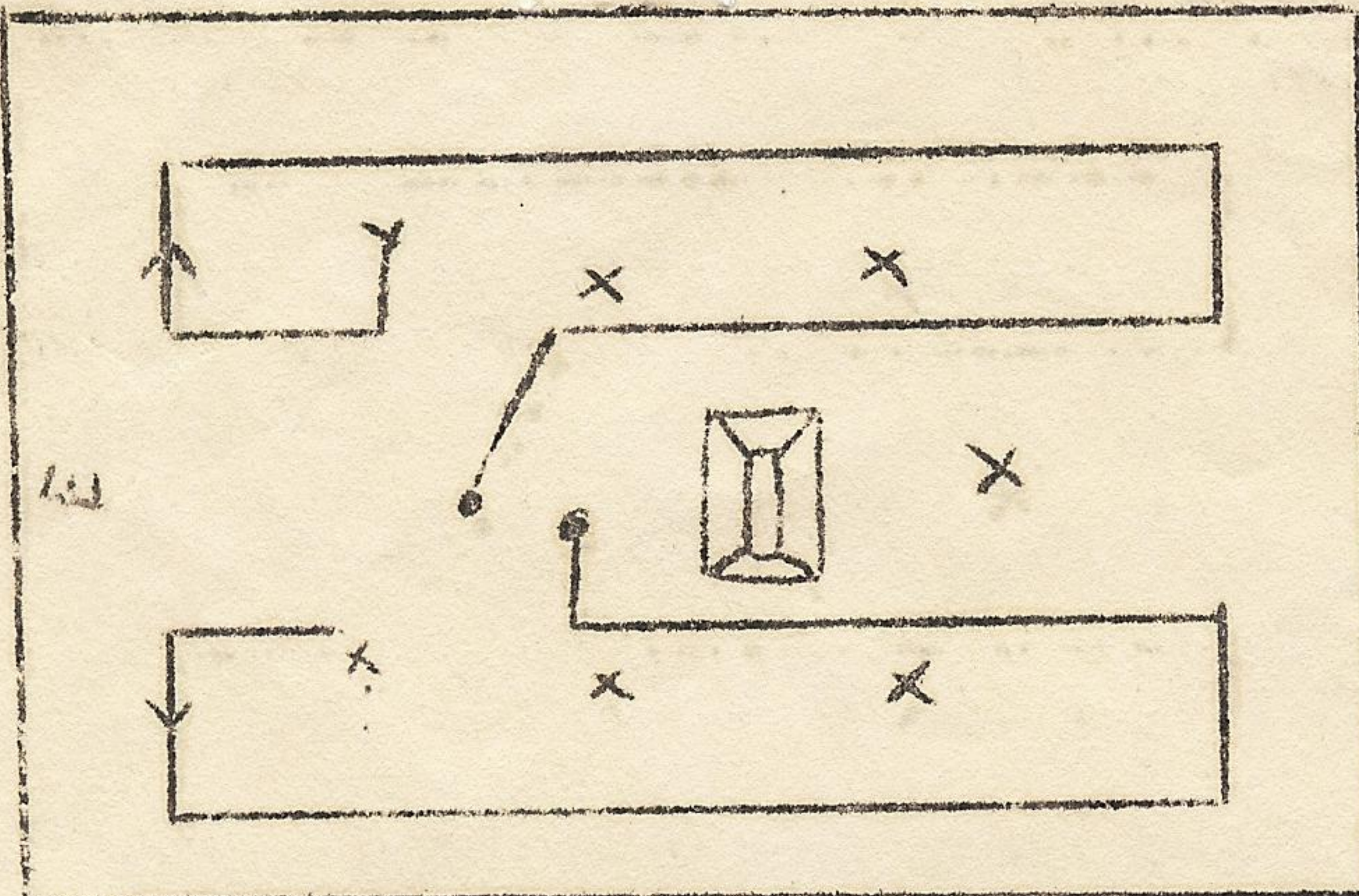

After the cross is formed the speaker says--

The religious leaders of the Jews had been responsible for the crucifixion of Christ. They then sought to bring the Christians into disrepute among the Romans by accusing them of sedition against the Roman Government. These accusations came from every province where Christianity had been established. As a result, about thirty years after the death of Christ persecution broke out against the Christians. This persecution lasted nearly three hundred years. It was not confined to Rome, but spread through out the Empire.

Knowing that Christianity had adopted the cross as an emblem of their faith, Nero sent soldiers out with crosses to be trampled under foot. When they reached the home of Electa a soldier handed her the cross upon which she was to trample.

"Electa looking him steadily in the face, received the cross, precious emblem of her Saviour's death--pressed it with ardor to her bosom and cast her eyes upward as a testimony of her love and loyalty to her Christian faith."

Song--Solo "Must Jesus Bear the Cross Alone?"

At the close of the song "Onward Christian Soldiers" is played for marching.

The sisters march out of the cross, seven to the North and Seven to the south side of the Chapter room. They leave their candles as they go at the following places. Two at the Matron's and Patron's station; two at the Secretary's desk; two at the Treasurer's desk; (if she has no desk these may be placed on the piano) one each at the stations of the Conductress and Associate Conductress; and two at the Associate Matron's station. The other four are left on each corner of the Altar as the last four in line pass.

The two leaders meet at the station of the Associate Matron. The line marches in two columns dividing at Esther's station, and makes a complete circle around the Altar outside the Labyrinth. When the circle has been formed all stop and face the Altar.

Music--Onward Christian Soldiers.

Electa Night--Con't

At the close of the talk the fourteen sisters march in a complete circle singing "Onward Christian Soldiers" the sister who entered the Chapter room door leading. When the line of march comes to Esther's station the circle is broken and all march West and out of the Chapter room door.

The Speaker says--

Sisters and brothers, let us be loyal to our convictions of truth and may we murmur not at another's loyalty. Let truth be spoken and let it shine through our lives. If persecution comes may we bear it with heroic endurance and may we despair not at the final triumph of truth. Let us press with ardor the emblematic cross for it is by this sign we shall conquer.

If flowers are to be presented to Grand Electa or other honor guests the following verses may be used in the presentations.

Electa teaches us of truth and love,
Truly a blessing inspired from above,
In your year of service may there come to you,
True love and true friendship
That will last your life through.

As thru life's labyrinth you tread
May God shower His blessings upon your head.
Before you many joyous happy years are spread
These flowers express our wish,
They're a message from the red.

Our cup of hospitality
Is full to over flowing
And the red rose of loyalty within our Chapter is growing,
A hearty handclasp we extend dear sister to you,
With a prayer in our hearts that to ideals we'll be true.